

Foster -
LUZERNE.

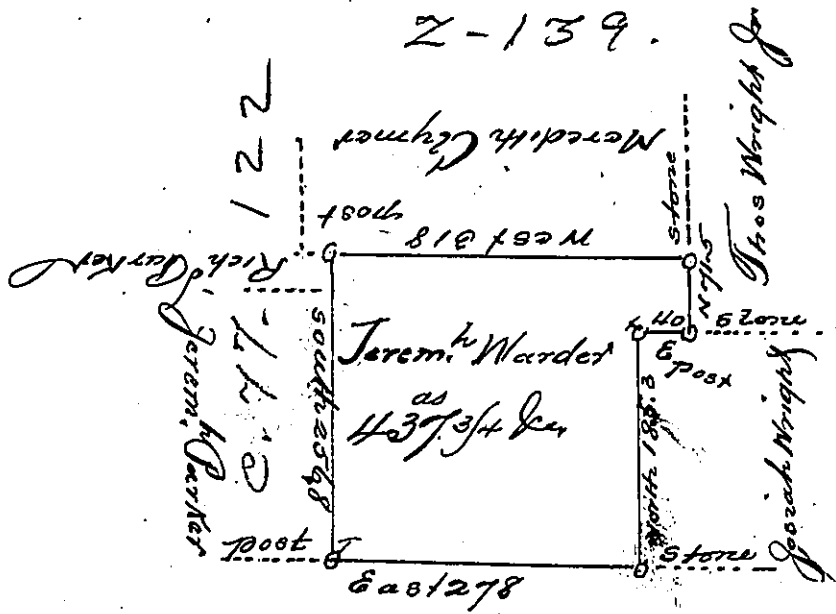
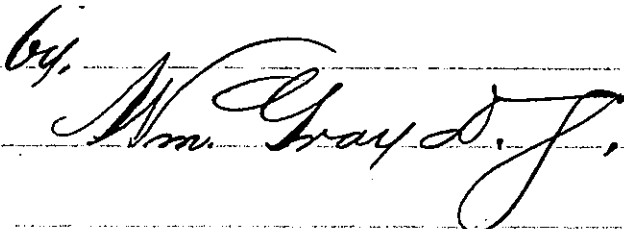

Vacant
A. 57. 90. = C. 52-139.

A draft of a Tract of Land called — situated in the County
 County of Luzerne. Containing Four hundred & thirty seven acres
 3/4 & a roland, surveyed for Jeremiah Wardet the 3^d day of May
 1793, in pursuance of a warrant dated the 12th day of Jan^y,
 1793.

by 
 Daniel Brodhead Esq^r.
 Jun^r. Gen^l.

IN TESTIMONY that the above is a copy of the original remaining on file in
 the Department of Internal Affairs of Pennsylvania, made
 conformably to an Act of Assembly approved the 16th day of
 February, 1833, I have hereunto set my Hand and caused
 the Seal of said Department to be affixed at Harrisburg,
 this second day of April, 1901.

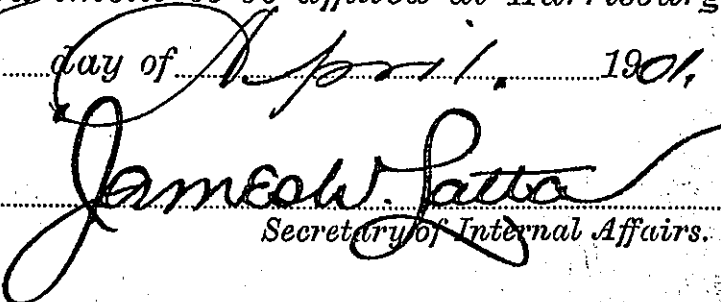
 Secretary of Internal Affairs.